

Fitting the cord guiding

Type R010

Fit the holder as described overleaf.

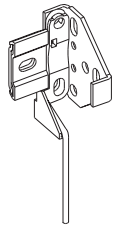

Wall mounting

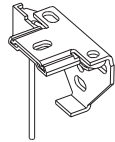

Ceiling mounting

Fit the shaft as described overleaf.

Fit the cord guiding

Thread the cord through the eye of the end cap on both sides.

Roll the blind down and mark the bottom position of the cord guiding on the window wing, the jamb or the window sill. For this, the cord should run through the exact centre of the eye on the end cap.

When mounting the cord guiding in the wing of the window or in the jamb, first fix the wall angle in the desired position and then fasten the fixing screw element onto the angle. When mounting on the window sill, the fixing screw element is screwed directly into the sill.

First slip the cover cap and then the adjusting ring onto the cord. Loosely screw the adjusting ring onto the bottom end of the cord

Hook the cord with the adjusting ring into the fixing screw element a) or into the block holder b). Shorten the cord below the adjusting ring to the desired length. Correct the tension of the cord by moving the adjusting ring. Tighten the adjusting ring.

Slip on the cover cap.

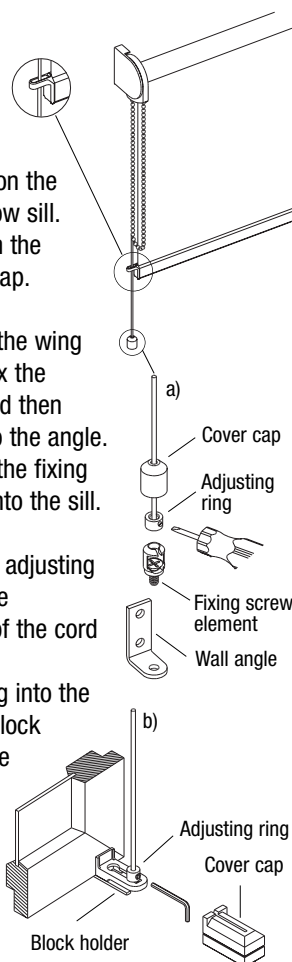

Roller blind with valance

Clip the pull strip with handle onto the middle of the valance closing profile on the rear side of the blind, like shown below.

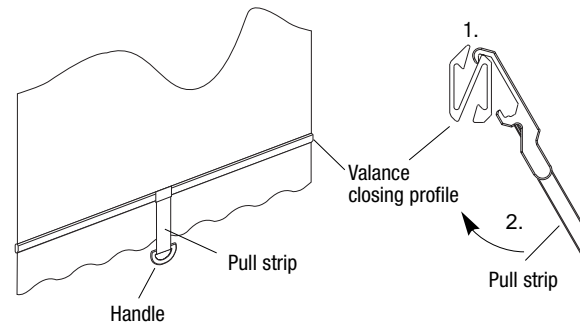

Operation

Type R010 is infinitely adjustable with the side chain pull.

Type R020 is operated by the desired pull element in the middle.

Care

Clean off any slight soiling of the fabric with a damp cloth. Then carefully rub the fabric dry. Brush off any dust.

Type R020: If the spring tension starts to weaken, pull the blind down by about 20-30 cm while in its assembled position on the window and let it click to a stop. Then remove the blind from the holders and roll the hanging completely up. Replace the blind completely rolled up. If necessary, this procedure can be repeated.

Δ Important! The chain pull gear (Type R010) is maintenance-free and must not be oiled.

DECOMATIC® ROLLER BLIND

Assembly – Operation – Care Types R010 and R020

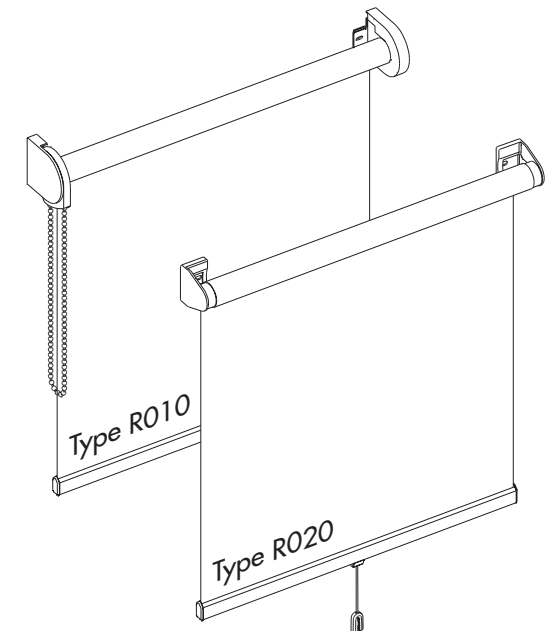

Dear customer,

This correctly dimensioned roller blind has been made especially for your requirements. High-quality materials and a design that is perfect in function and elegance guarantee a long service life and thus will give you a great deal of satisfaction from your purchase. Please read these instructions carefully before starting to assemble the blind. The required installation material is delivered together with each blind.

Your
DECOMATIC® ROLLER BLIND
Manufacturer

Mounting the holders

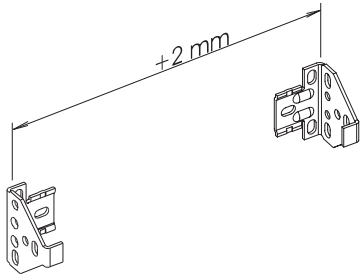

When mounting holders of all types make sure that the distance between the holders is approx. 2 mm longer than the length of the shaft (to fix the holders to the wall or ceiling please use the 3.9 x 32 mm screws and 6 mm screw plugs delivered with the blind). Also make sure that the blind is mounted **horizontally**.

The following holders are suitable for screwing onto walls or ceilings.

Standard holder

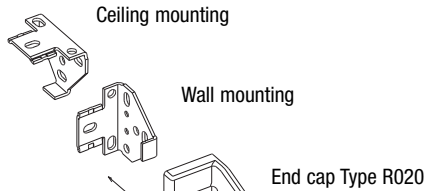

Holder, long

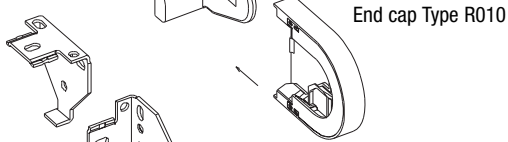

Holder, adjustable



Fitting the block holders

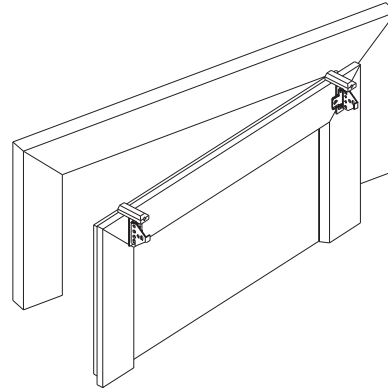

Fasten the block holder of the window frame with the hexagon socket screw key.

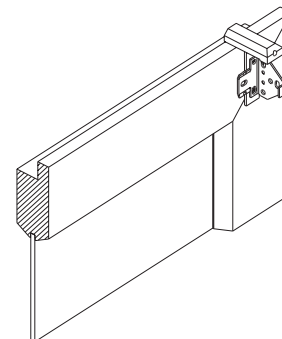
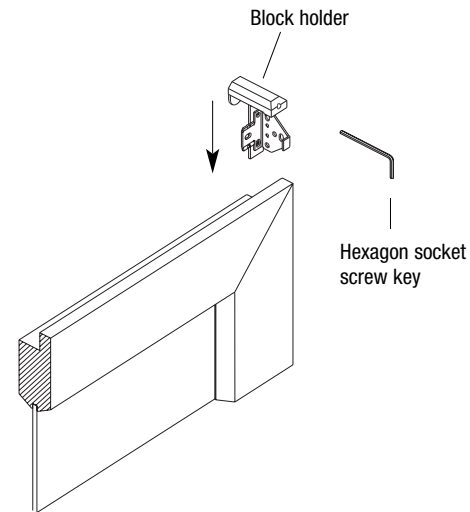

Fitting the shaft

Type R010

Roll the blind up and position the chain connector under the end cap by pulling on the ball chain. Connect the chain cog wheel including the pull chain to the shaft.

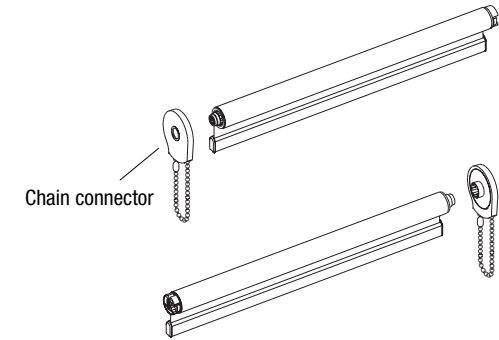

Then insert first the operating end (1.) and then the thrust bearing end (2.) into the holders and fit the end caps.

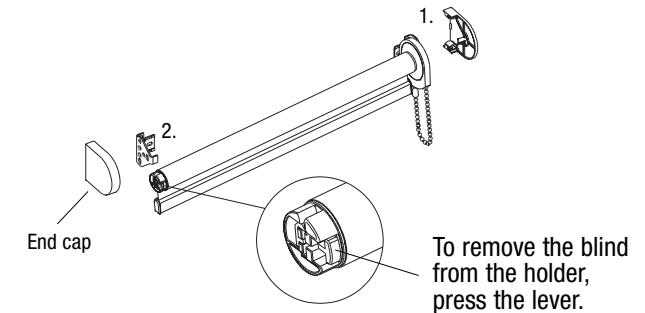

Roll the blind down. Clip the stopper onto the chain just below the end cap.

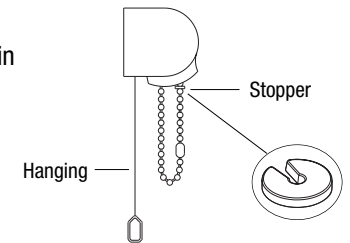

Type R020

Fit the end caps. Then insert first the operating end (1.) and then the thrust bearing end (2.) into the holders.

